

WHITE

DESIGN RODOLFO DORDONI

A seating system that offers a clustering of perfectly balanced shapes in an exquisite interplay of alternating positive and negative volumes.

The arrangement depicted is just one example of the many different compositions possible with our seating systems. We suggest that you contact the nearest Minotti dealer to explore the options most suited to your needs and select the upholstery of your choice from the exclusive Minotti collection.



WHITE — arrangement 09

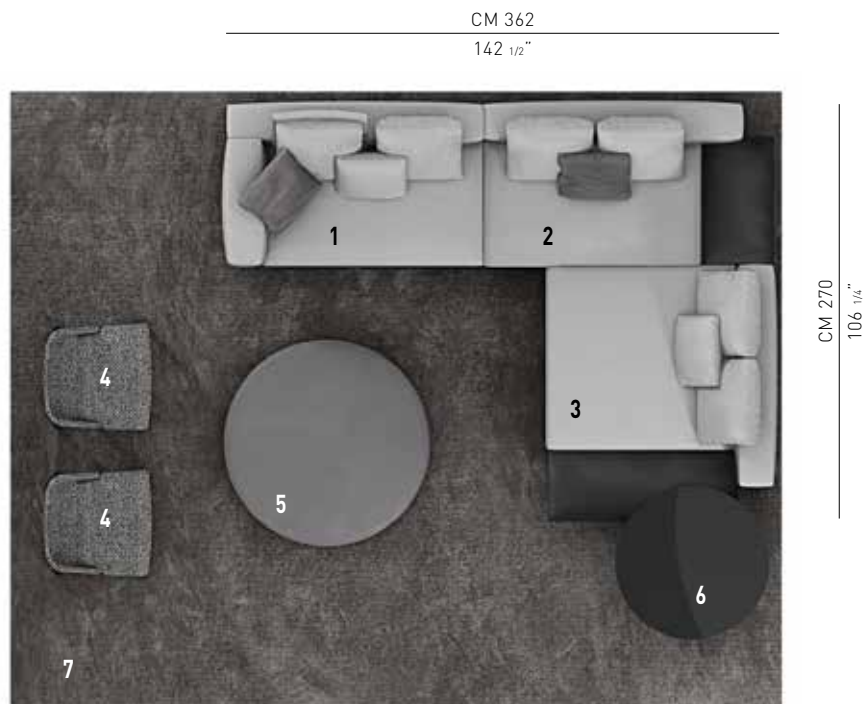

SOFA ARRANGEMENT

- 1 **WHITE**
ELEMENT WITH 1 ARMREST SX
CM 170X103 H89
- 2 **WHITE**
ELEMENT WITH TOP DX
CM 192X103 H89-TOP CM 44X82
- 3 **WHITE**
SOFÀ CHAISE-LONGUE ISLE DX
CM 167X145 H89-TOP CM 44X117

FURNISHING ACCESSORIES

- 4 **OWENS "ARMCHAIR"**
ARMCHAIR CM 72X72 H76
- 5 **DENNY**
OTTOMAN Ø CM 135 H32
- 6 **NETO**
COFFEE TABLE Ø CM 100 H40
- 7 **DIBBETS**
RUG CM 500X500

Furnishing accessories



4
OWENS "ARMCHAIR"
ARMCHAIR CM 72X72 H76



5
DENNY
OTTOMAN Ø CM 135 H32



6
NETO
COFFEE TABLE Ø CM 100 H40



7
DIBBETS
RUG CM 500X500